



# Instruction manual

Galilei P1 240V  
with canopy

**Tillykke med Deres nye Darø lampe!**

*- vi anbefaler at følge denne vejledning nøje for korrekt montering.*

**Congratulations on your new Darø lamp!**

*- we recommend following these instructions carefully for proper installation.*

## Montering af ophæng / How to assemble suspension

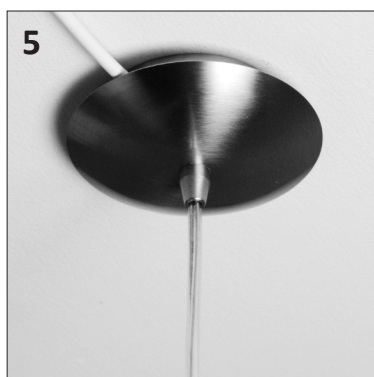
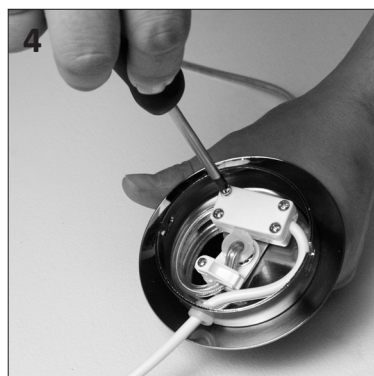
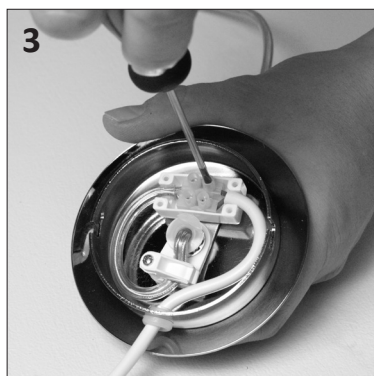
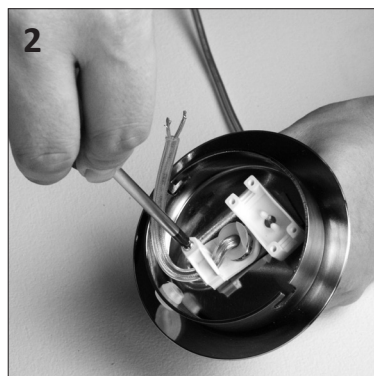
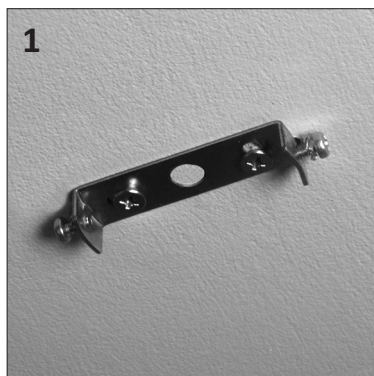

## Montering af glas

### How to assemble the glass

Inden omløberringen spændes helt fast, rettes glasset til, så det hænger lige.

Before the fastening ring is tightened, please adjust the glass to the center so that it hangs straight.

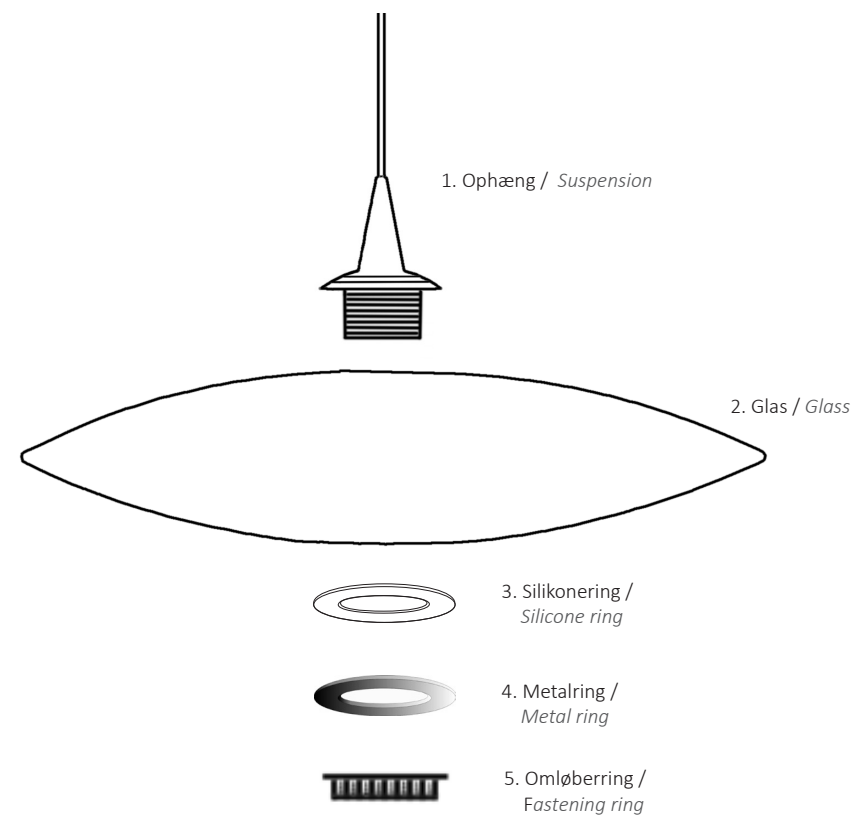

Du kan hjælpe med at beskytte miljøet! Respektér venligst de lokale regler: Aflever det defekte elektriske udstyr på det lokale affalds-/genbrugscenter. You can help protect the environment! Please respect the local rules: Pass the faulty electrical equipment at the local waste recycling center.

Reklameringsretten bortfalder i tilfælde af ukorrekt anvendelse, forfalskning eller sletning af mærkning. No warranty in case of incorrect use, falsification or erasure of labeling.

Produceret i Danmark / Produced in Denmark. - Darø a/s, Ribevej 8, 8940 Randers SV